

Immersible and Portable

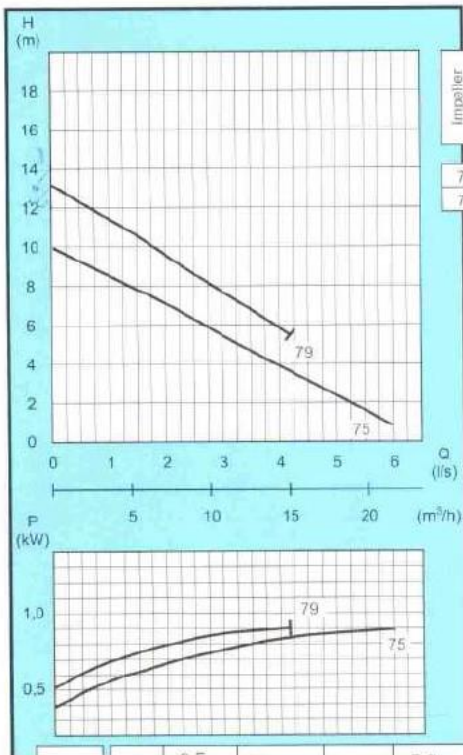

Impeller code	Type			Weight equipment (kg)
	Immersible	Portable	Dry	
75	•	•		18
79	•	•		

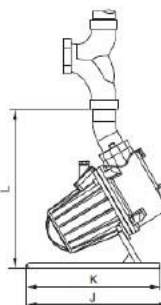
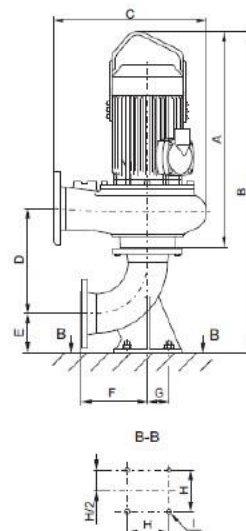
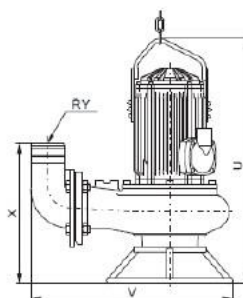
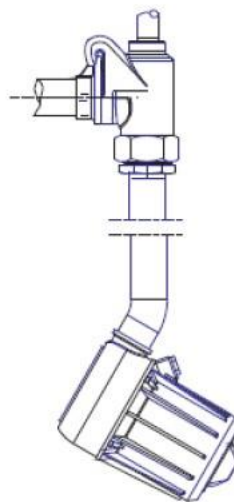
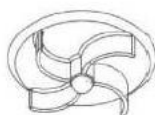

Impeller code	Type	Force pipe connection (DN)	Free flow cross-section (Ø mm)	Rated power (kW)	Revolution per minute (r.p.m)	Rated current consumption (A)	Starting current consumption (A)	Cos φ	Cable cross-section (mm²)
230 V, 50 Hz (230V)									
75	01.275	40	35	1,35	2800	6,3	16,8	0,89	1,5
79	01.279								

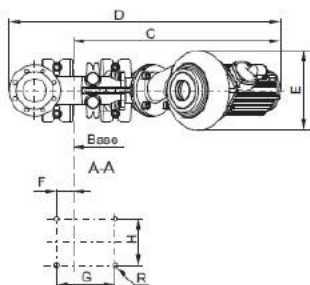
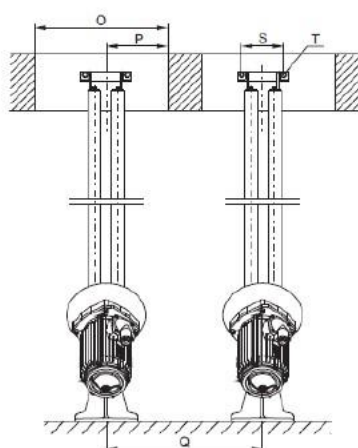
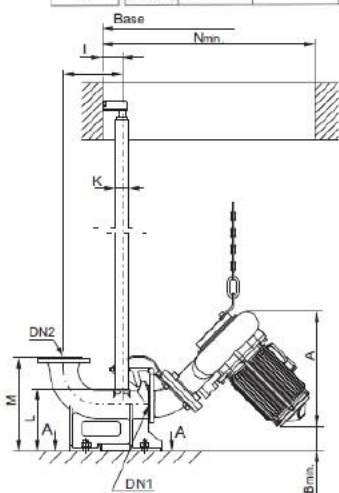

Type	DN	A	Bmin	C	D	E	F	G	H	I	J	K	L	M	Nmin	O	P	Q	R	S	T	DN1	DN2
	mm																						
AKD-01	40	290			300	160									600	400	~200					42/30	42/30