

Impeller code	Type		
	Immersible	Portable	Dry
62	●	●	●
63	●	●	○
64	●	●	○
65	●	●	●

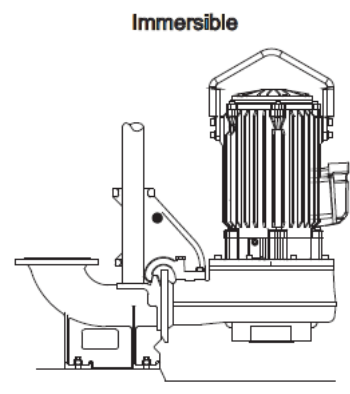

Immersible

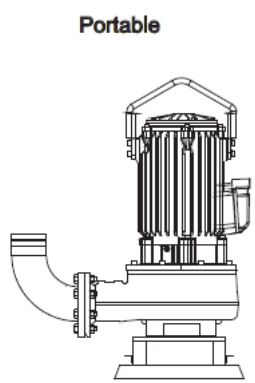

Portable

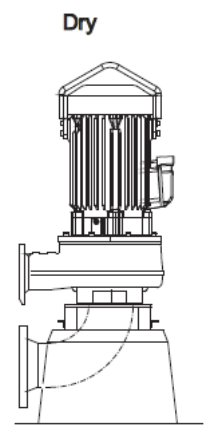

Dry

Impeller code	Type	Force pipe connection (DN)	Free flow cross-section (Ø mm)	Rated power (kW)	Revolution per minute (r.p.m)	Rated current consumption (A)	Starting current consumption (A)	Cos φ	Cable cross-section (mm²)	
400 V, 50 Hz (400/230V or 690/400V)										
62*	89.262	100	76	37	2965	64	480; 160	0,88	25; 16	
63*	89.263			30	2960	52	395; 125			
64*	89.264									
65*	89.265									

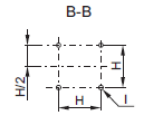
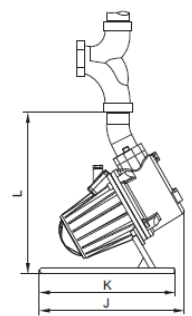
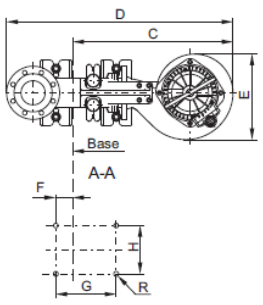
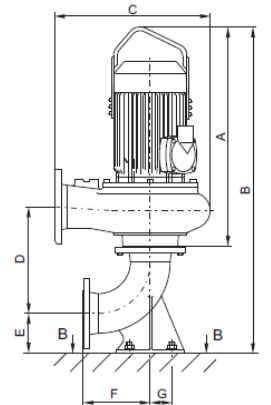
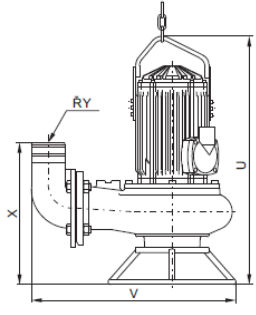
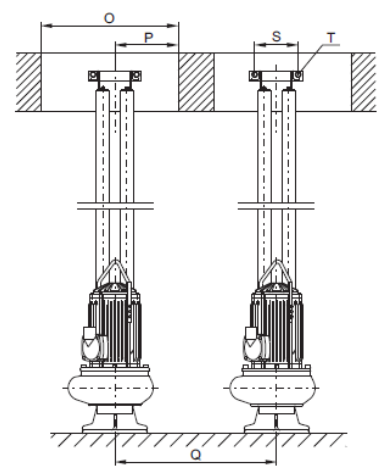
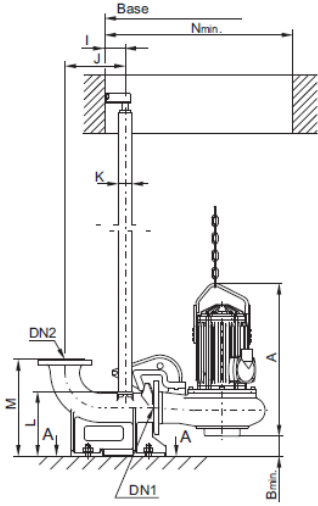

Type	DN	A	Bmin	C	D	E	F	G	H	I	J	K	L	M	Nmin	O	P	Q	R	S	T	DN1	DN2
	mm																						
KC-89.26	100/100	1155	160	965	1190	540	69	250	200	135	249	3"	260	400	1600	800	300	~1000	M20	115	M16	100	100